

MV112 Marine Grade IP67 Voice Annunciation unit



comsec
protection systems



A heavy duty high output IP67 sealed voice annunciation sounder, ideal for harsh environments with high ambient noise levels.

- Maximum output: 110dB(A) @ 1 metre
Voice output : approx. 105dB(A) @ 1m +/-3dB
- Direct message storage on silicon: 16 seconds of speech
- Very high voice reproduction quality (moving coil loudspeaker)
- 10 alarm tones (including silence to allow speech only option) UKOOA/PFEER compliant.
- Volume control & tone duration control.
- Message length: 1 x 16 seconds or 2 x 8 seconds.
- 100m effective range @ 1kHz
- Voltages: 12vdc(9-15vdc); 24vdc(18-30vdc); 115vac; 230vac.
- Easy message creation with built in microphone.
- Edits automatically to message length.
- Third party tested to IP67 & IP66
- Enclosure material : UL94V0 & 5VA rated FR ABS
- Colour available : Grey (RAL7038)
- Operating temperature : -25 to +55°C
- Storage temperature : -40 to +70°C
- Relative humidity : 90% at 20°C
- Weight : DC: 2.50Kg AC: 3.00Kg

- Large termination area
- 2 x M20 ISO cable gland entries (with 1 blanking plug).
- Ratchet adjustable stainless steel 'U' bracket for 360° positioning.
- Terminals accept 0.5 to 4.0mm² cables.

The sounder records, stores and plays back user defined messages stored directly to non-volatile memory without any intermediate analogue to digital conversion.

A single 16 second, or two 8 second messages may be recorded and played back with a choice of 1 of 10 user selectable alarm tones.

Input voltages and current consumption for the MV112 sounder.

Voltage :	12vdc	24vdc	115vac	230vac
			50/60Hz	50/60Hz
Voltage range :	9-15vdc	18-30vdc	+/-10%	+/-10%
Current mA :	400mA	440mA	200mA	90mA

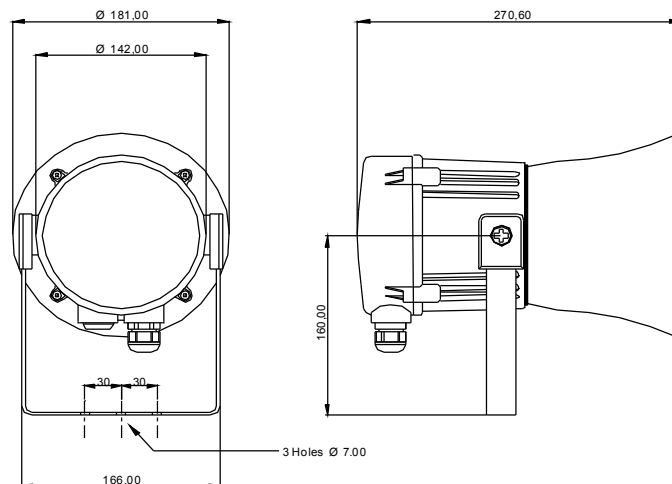





All dimensions are in millimetres.

Also available :

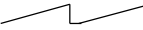
- MCA112-05** combined sounder & beacon
- ML15** 15w & **ML25** 25w marine loudspeaker
- MA112** & **MA121** high output marine sounders
- MB005** & **MB010** 5 and 10 Joule marine beacons
- MCV112-05** combined voice annunciation unit



Stage 1	Frequency Description	dB @ 1m	Cycles
Tone 1	800/1000Hz @ 0.25 sec Alternating	110dB(A) @ 1m	 4 cycles
Tone 2	500/1200Hz @ 0.3Hz 0.5 sec Slow Whoop	110dB(A) @ 1m	 2 cycles
Tone 3	1200/500Hz @ 1Hz - DIN / PFEER P.T.A.P.	110dB(A) @ 1m	 4 cycles
Tone 4	544Hz (100mS)/440Hz (400mS) - NF S 32-001	108dB(A) @ 1m	 4 cycles
Tone 5	1000Hz Continuous - PFEER Toxic Gas	110dB(A) @ 1m	————— 2 cycles
Tone 6	Bell	104dB(A) @ 1m	 2 cycles
Tone 7	1KHz 1s on, 1s off Intermittent - PFEER Gen. Alarm	110dB(A) @ 1m	— — — — — 3 cycles
Tone 8	420Hz @ 0.625 sec Australian Alert	107dB(A) @ 1m	— — — — — 4 cycles
Tone 9	500-1200Hz 3.75sec /0.25sec. Australian Evac.	110dB(A) @ 1m	 2 cycles
Tone 10	No tone - 0.5 second gap		

Note: SPL readings are at nominal voltage, typically +/-3dB and are for indication purposes only. Where applicable, reduce outputs by 5dB when a 10-30vdc unit is supplied 12vdc.

DC unit wiring configuration.

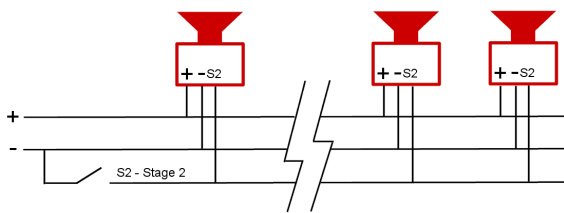

AC unit wiring configuration.

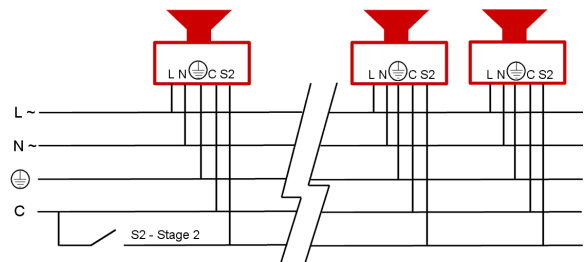

Ordering code :

